

## **Directions to Summer Knights VII Tournament**

*There are 10 sites at which games will be held:*



1. **The Complex (COMPLEX 1, 2, 3, 4)**  
450 SW Campus Drive  
Federal Way, WA 98023
2. **Decatur High School (DHS 1, DHS 2)**  
2800 SW 320<sup>th</sup>  
Federal Way, WA 98023
3. **Enterprise Elementary School (ENT)**  
35101 5th Ave SW  
Federal Way, 98023
4. **Federal Way High School (FW1, FW2)**  
1300 S 308<sup>th</sup> St  
Federal Way, WA 98003
5. **Ilaha Middle School (ILL)**  
36001 1<sup>st</sup>. Ave S  
Federal Way, WA 98003
6. **Lakota Middle School (LAK)**  
1415 SW 314<sup>th</sup> St  
Federal Way, WA 98023
7. **Sacajawea Middle School (SAC 1&2 lower & SAC LL 1&2 upper)**  
1101 S. Dash Point Rd  
Federal Way, WA 98003
8. **Saghalie Middle School (SAG 3, 4)**  
33914 19th Ave SW  
Federal Way, WA 98023
9. **Steel Lake Annex (SL 1, SL 2)**  
2620 S 312th St  
Federal Way, WA 98003
10. **Todd Beamer High School (TBHS)**  
35999 16<sup>th</sup> Ave S  
Federal Way, WA 98003

## The Complex (Complex 1, 2, 3, 4)

500 SW Campus Drive  
Federal Way, WA 98023



### **Directions from I-5:**

- Head North or South I-5 toward Federal Way.
- Take Exit 142B (348<sup>th</sup> St.)
- Go West on S. 348<sup>th</sup> (becomes S.W. Campus Dr.)
- Cross 1<sup>st</sup> Avenue, past IHOP and WINCO.
- Fields will be on the right. (We are 2 miles from I-5)

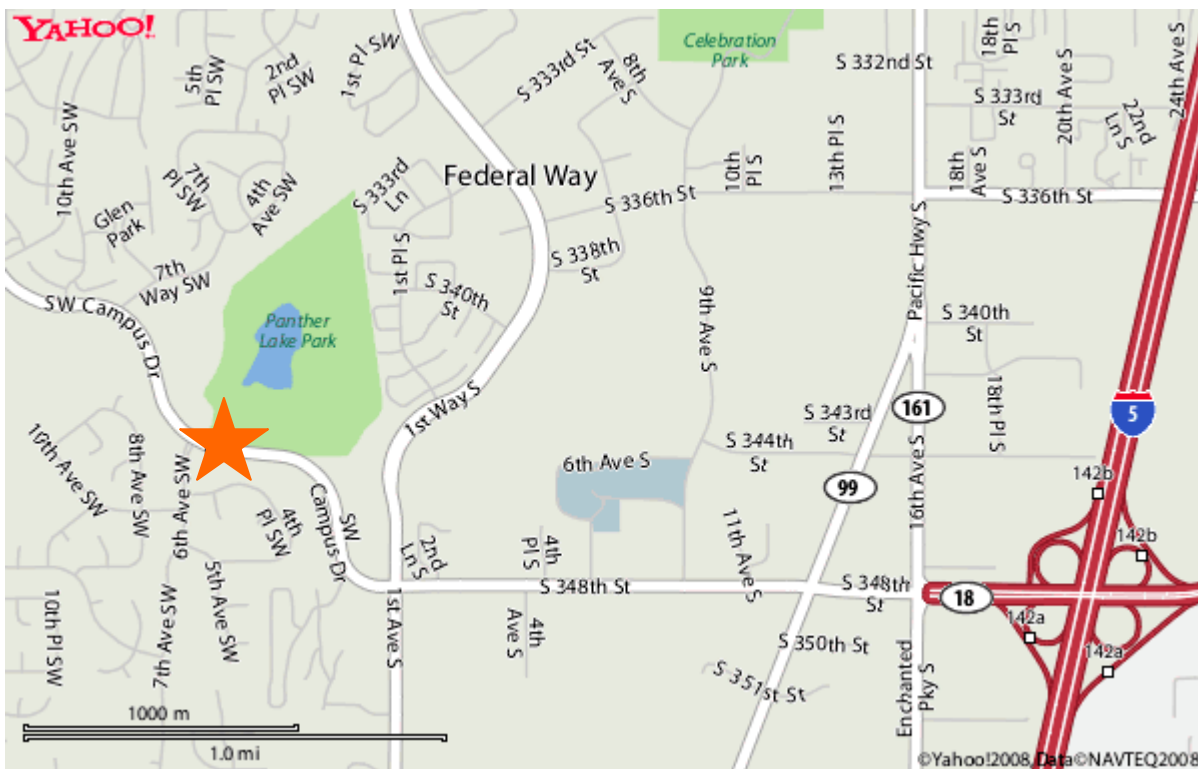

# Decatur High School (DHS 1, DHS 2)

2800 SW 320<sup>th</sup>  
Federal Way, WA 98023



## ***Directions from I-5:***

- Head North or South I-5 toward Federal Way.
- Take Exit 143 (S. 320<sup>th</sup> St.)
- Go West on 320<sup>th</sup> St. for approximately 3.5 miles.
- Turn right at 30<sup>th</sup> Ave. S.W. (field is on right).

## ***Directions from the Complex:***

- Turn right out of Complex onto SW Campus Drive (becomes SW 336<sup>th</sup> St.)
- Turn right at 21<sup>st</sup> Ave. S.W.
- Turn left at SW 320<sup>th</sup> St.
- Turn right at 30<sup>th</sup> Ave. S.W. (field is on right)

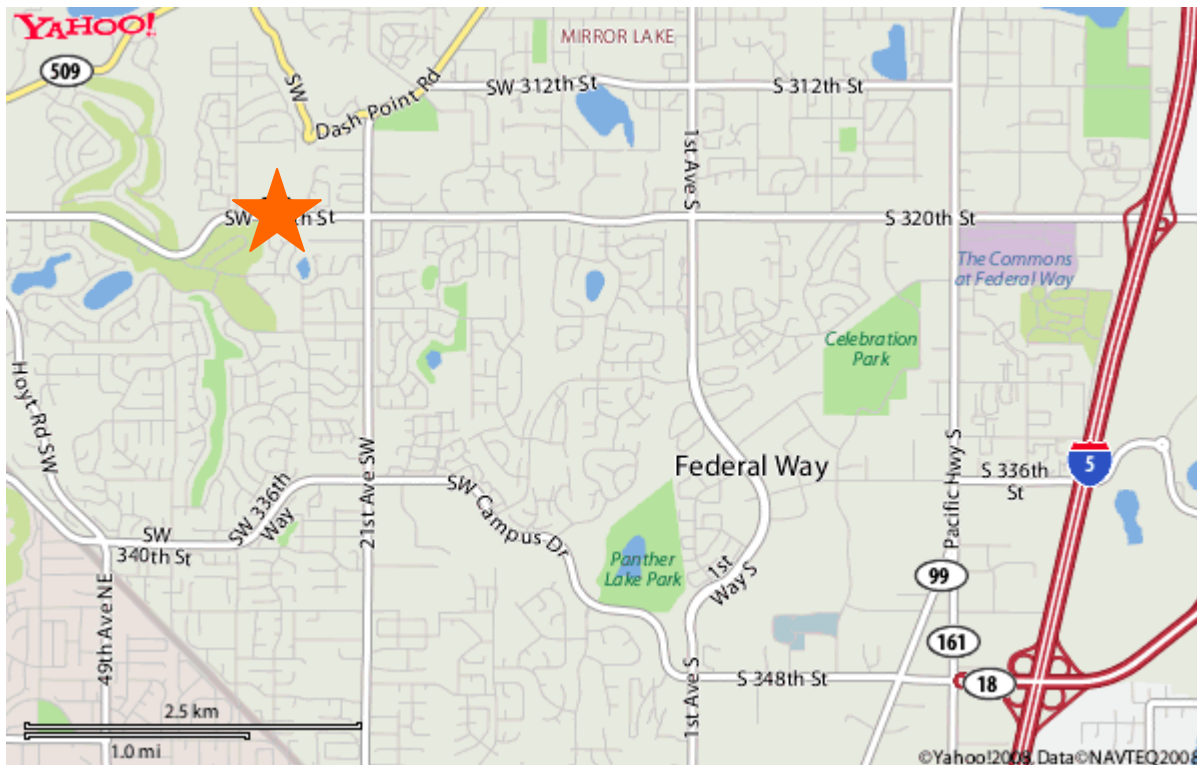

## Enterprise Elementary School (ENT)

35101 5th Ave SW  
Federal Way, 98023



### **Directions from I-5:**

- Head North or South I-5 toward Federal Way.
- Take Exit 142B (348<sup>th</sup> St.)
- Go West on S. 348<sup>th</sup> (becomes S.W. Campus Dr.)
- Cross 1<sup>st</sup> Avenue, pass IHOP, WINCO and Baseball Complex on right.
- Turn Left onto 6TH AVE SW (the King County Aquatic Center is to the right of this intersection) – go 0.1 mi
- 6TH AVE SW becomes 7TH AVE SW – go 0.2 mi
- A sign for Enterprise will signal a Left Turn onto SW 352ND ST – go 0.1 mi.
- Turn Left onto 5TH AVE SW (Enterprise Access)

### **Directions from the Complex:**

- Turn right out of Complex.
- Turn left at first light 6<sup>th</sup> Ave SW (the King County Aquatic Center is to the right of this intersection)
- 6TH AVE SW becomes 7TH AVE SW – go 0.2 mi
- A sign for Enterprise will signal a Left Turn onto SW 352ND ST – go 0.1 mi.
- Turn Left onto 5TH AVE SW (Enterprise Access)

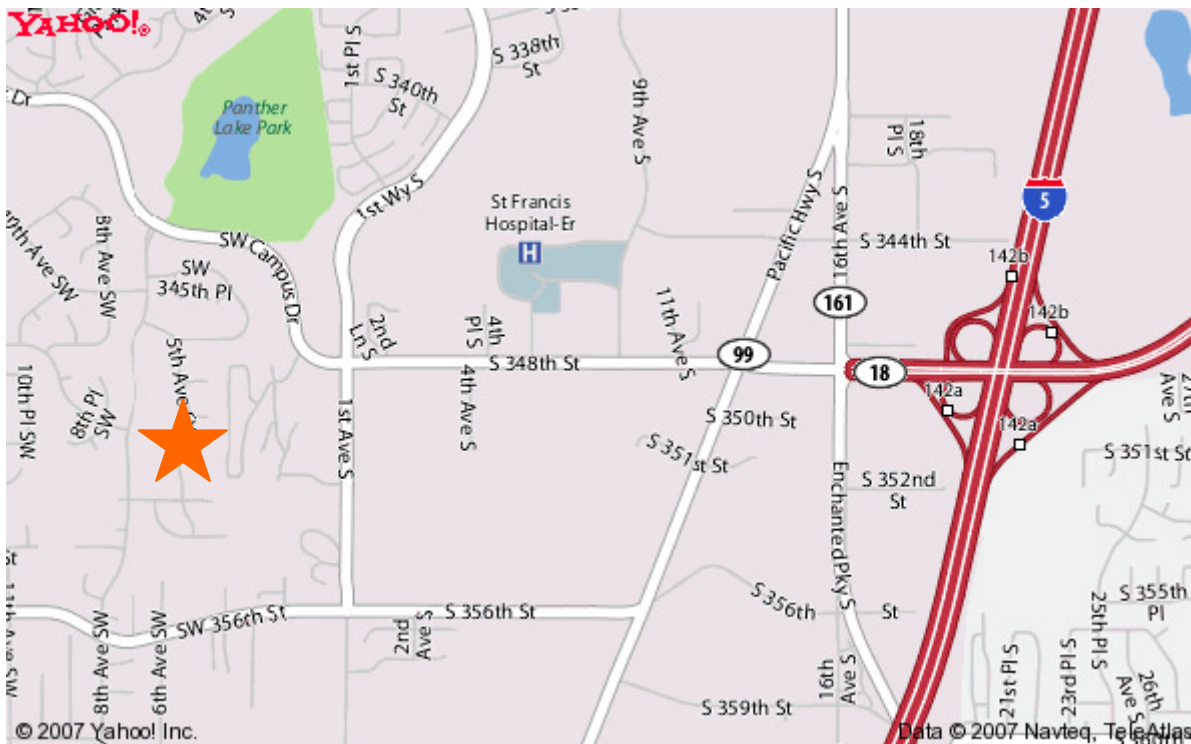

# Federal Way High School (FW 1, FW 2)

1300 S 308<sup>th</sup> St  
Federal Way, WA 98003



## **Directions from I-5:**

- Head North or South I-5 toward Federal Way.
- Take Exit 143 (S. 320<sup>th</sup> St.)
- Go West on 320<sup>th</sup> St. for approximately .75 miles.
- Turn right at Pacific Highway South.
- Turn left at S. 308<sup>th</sup> St.

## **Directions from the Complex:**

- Turn left out of Complex onto SW Campus Drive (becomes SW 348<sup>th</sup> St.)
- Turn left at Pacific Hwy S.
- Follow Pacific Hwy S. for several lights.

## **Upper field (FW 2) :**

- Turn left at S. 308<sup>th</sup> St.
- Turn into parking lot on right before stadium. Field is behind tennis courts.

## **Lower field (FW 1):**

- Turn left at S. 304<sup>th</sup> St.
- Field will be on your left.

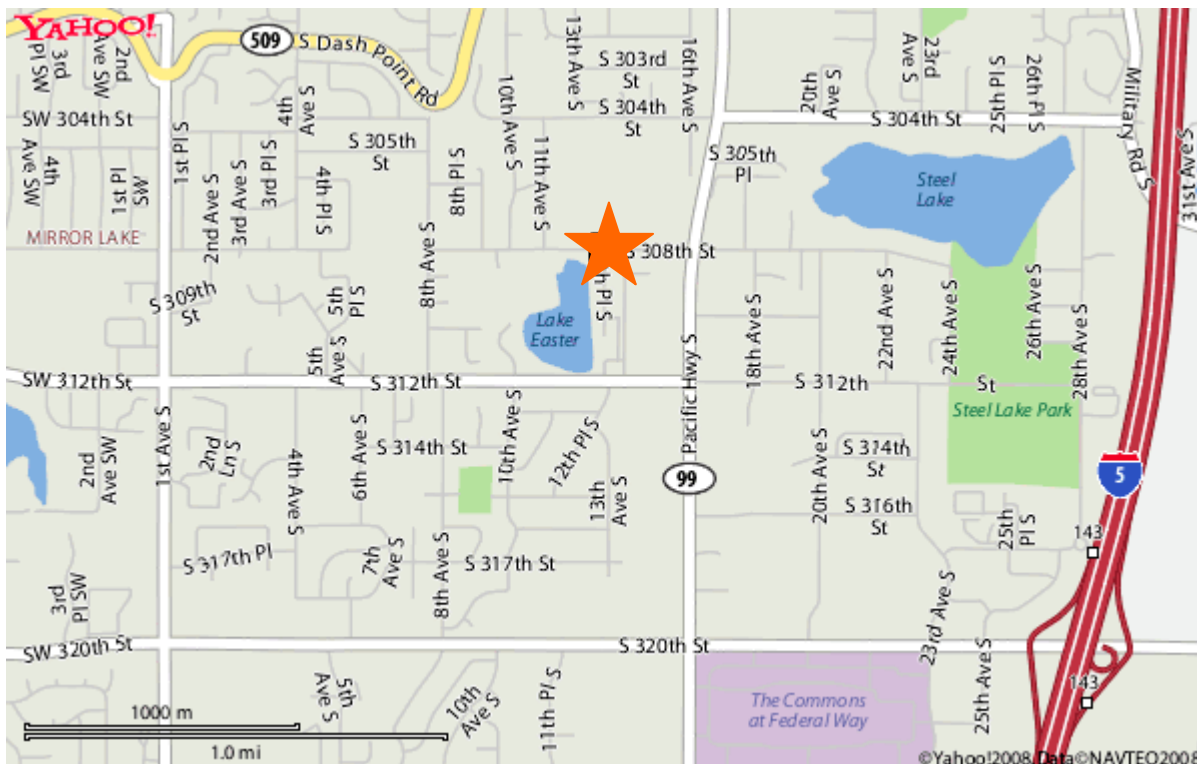

# Illahee Middle School (ILL)

36001 First Ave S  
Federal Way, 98003



## ***Directions from I-5:***

- From I-5 take EXIT 142 B, go west to S 348<sup>th</sup> ST.
- Go about 1 ¾ miles to 1<sup>st</sup> Ave. S turn left (south) onto 1<sup>st</sup> Ave. S
- Continue on 1<sup>st</sup> Ave. S, past S 356<sup>th</sup> ST. Illahee will be on the right about 3 blocks past S 356<sup>th</sup> ST

## ***Directions from the Complex:***

- Take a left out of parking lot
- Go about 1/2 mile to 1<sup>st</sup> Avenue S turn right (south) onto 1<sup>st</sup> Avenue South
- Continue on 1<sup>st</sup> Avenue S, past S 356<sup>th</sup> ST. Illahee will be on the right about 3 blocks past S 356<sup>th</sup> ST

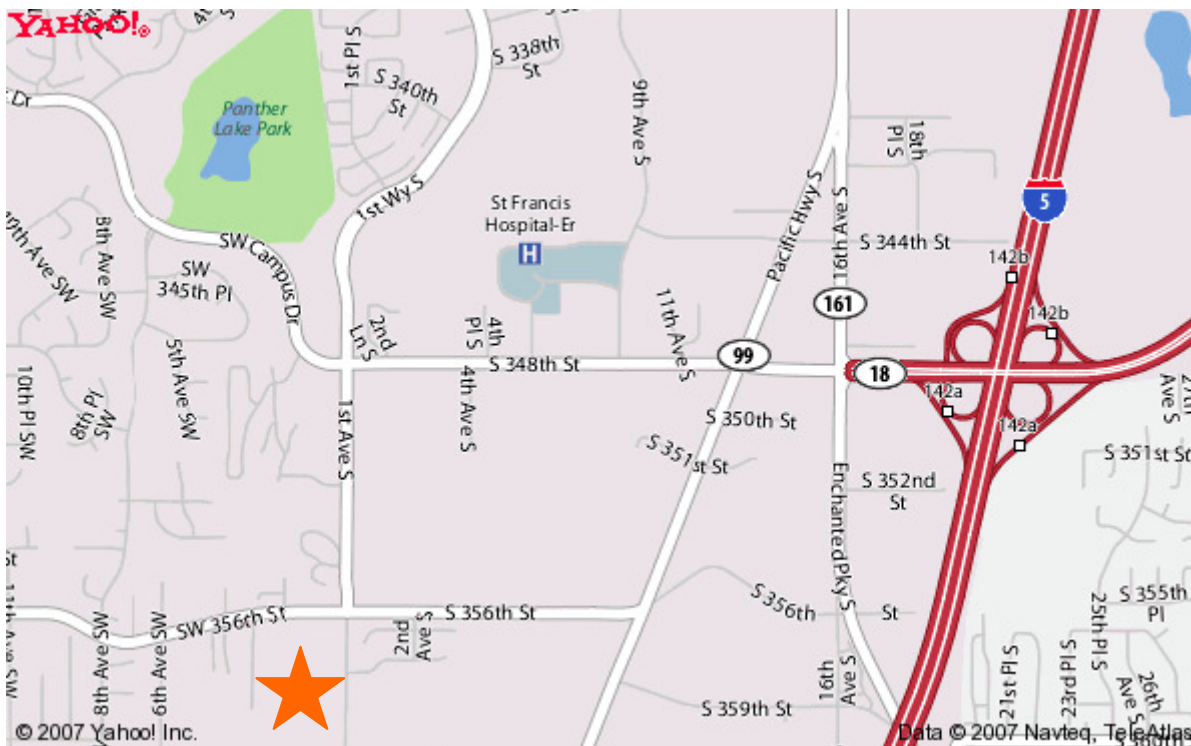

## Lakota Middle School(LAK)

1415 SW 314<sup>TH</sup> ST  
Federal Way, 98023



### **Directions from I-5:**

- From I-5 take the S 320<sup>th</sup> ST exit (EXIT #143); turn west onto S 320<sup>th</sup> ST.
- Go about 2 miles turn right onto 21<sup>st</sup> Ave SW
- Lakota Field is about ½ mile on the right.

### **Directions from the Complex:**

- Turn right out of parking lot onto SW Campus Dr.
- Continue to 21<sup>st</sup> Ave SW
- Turn right onto 21<sup>st</sup> Ave SW
- Continue across S 320<sup>th</sup> ST
- Lakota Field is about ½ mile on the right.

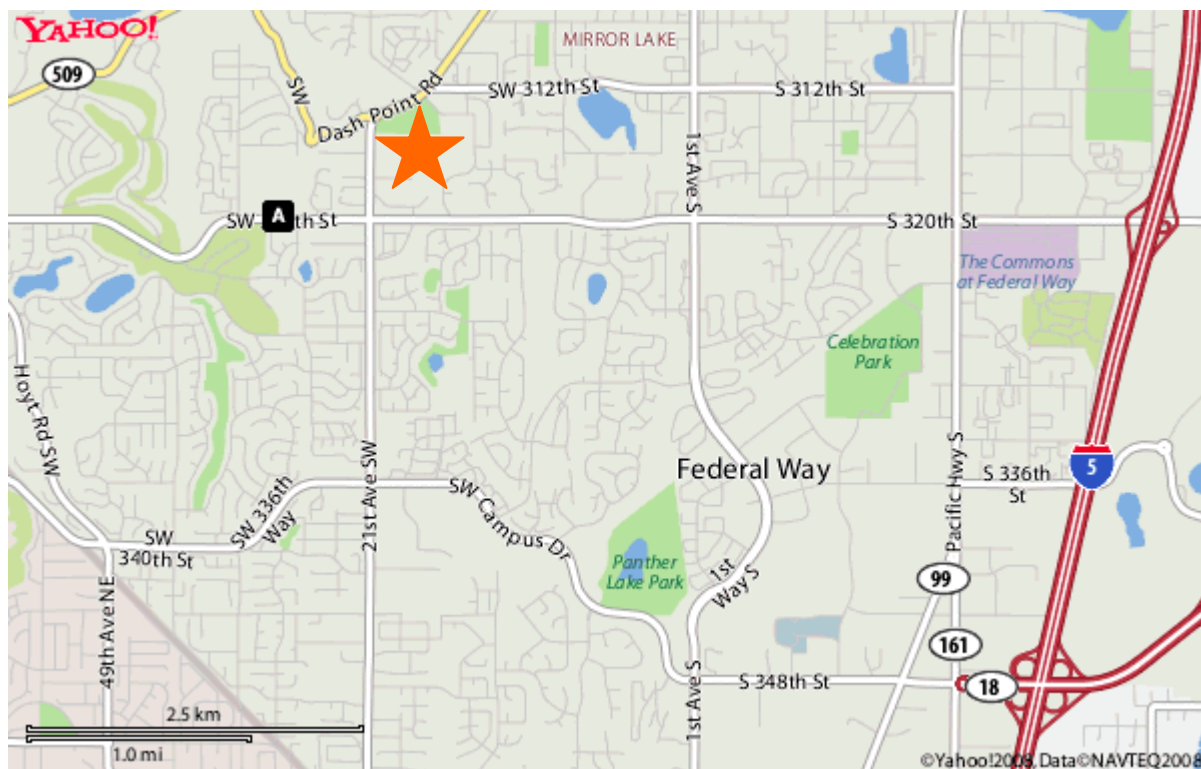

# Sacajawea Middle School (SAC)

1101 S. Dash Point Rd  
Federal Way, WA 98003



## **Directions from I-5:**

- Head North or South I-5 toward Federal Way.
- Take Exit 143 (S. 320<sup>th</sup> St.).
- Turn right at Pacific Highway South and travel through 4 lights.
- Turn left at S. Dash Point Road (5<sup>th</sup> light).
- Parking lot to fields is about ¼ mile on the left.

## **Directions from the Complex:**

- Turn left out of Complex onto SW Campus Drive (becomes SW 348<sup>th</sup> St.)
- Turn left at Pacific Hwy S.
- Follow Pacific Hwy S. to S. Dash Point Road.
- Turn left at S. Dash Point Road.
- Parking lot to fields is about ¼ mile on the left.

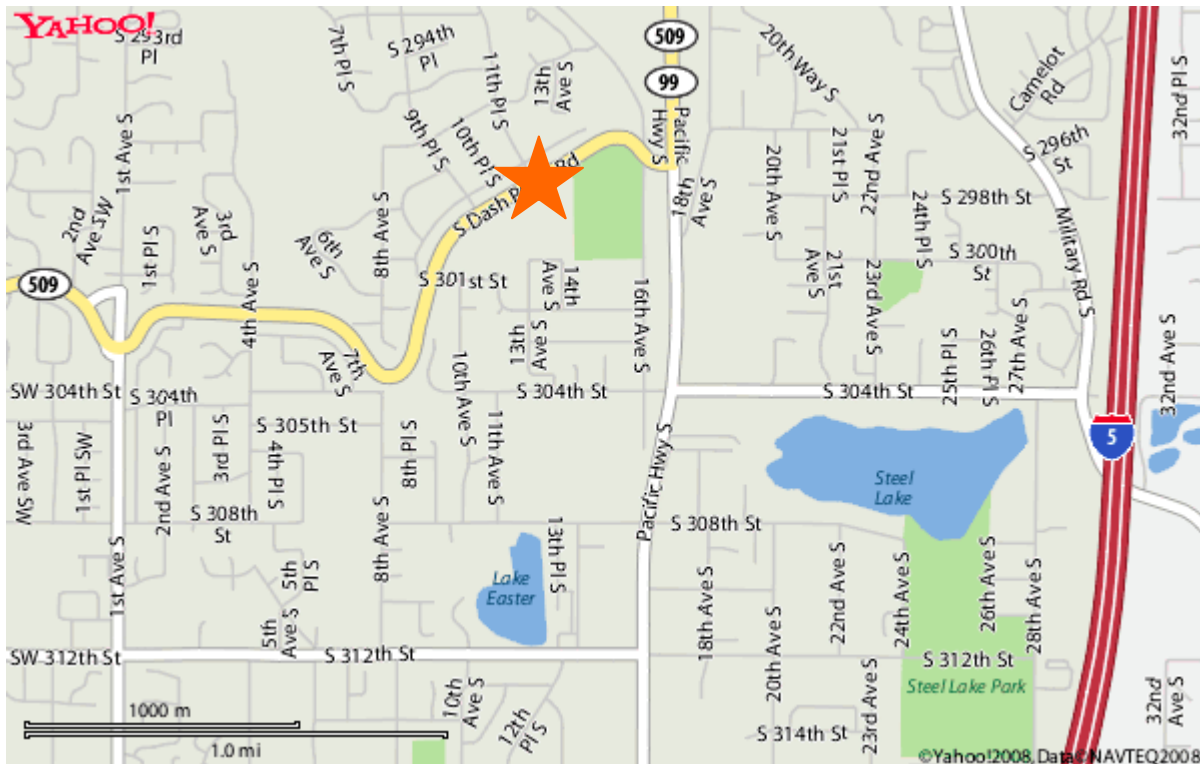

## Saghalie Middle School (SAG 3, 4)

33914 19<sup>th</sup> Ave SW  
Federal Way, WA 98023



### ***Directions from I-5:***

- Head North or South I-5 toward Federal Way.
- Take Exit 142B (348<sup>th</sup> St.)
- Go West on S. 348<sup>th</sup> (becomes SW Campus Drive then 336<sup>th</sup> St.) to 19<sup>th</sup> Ave. SW
- Turn left at 19<sup>th</sup> Ave. SW (just past the Post Office).
- Wind back behind the Post Office and take a left into the Saghalie parking lot.

### ***Directions from the Complex:***

- Turn right out of Complex onto SW Campus Drive (becomes SW 336<sup>th</sup> St.)
- Turn left at 19<sup>th</sup> Ave. S.W. (just past the Post Office).
- Wind back behind the Post Office and take a left into the Saghalie parking lot.

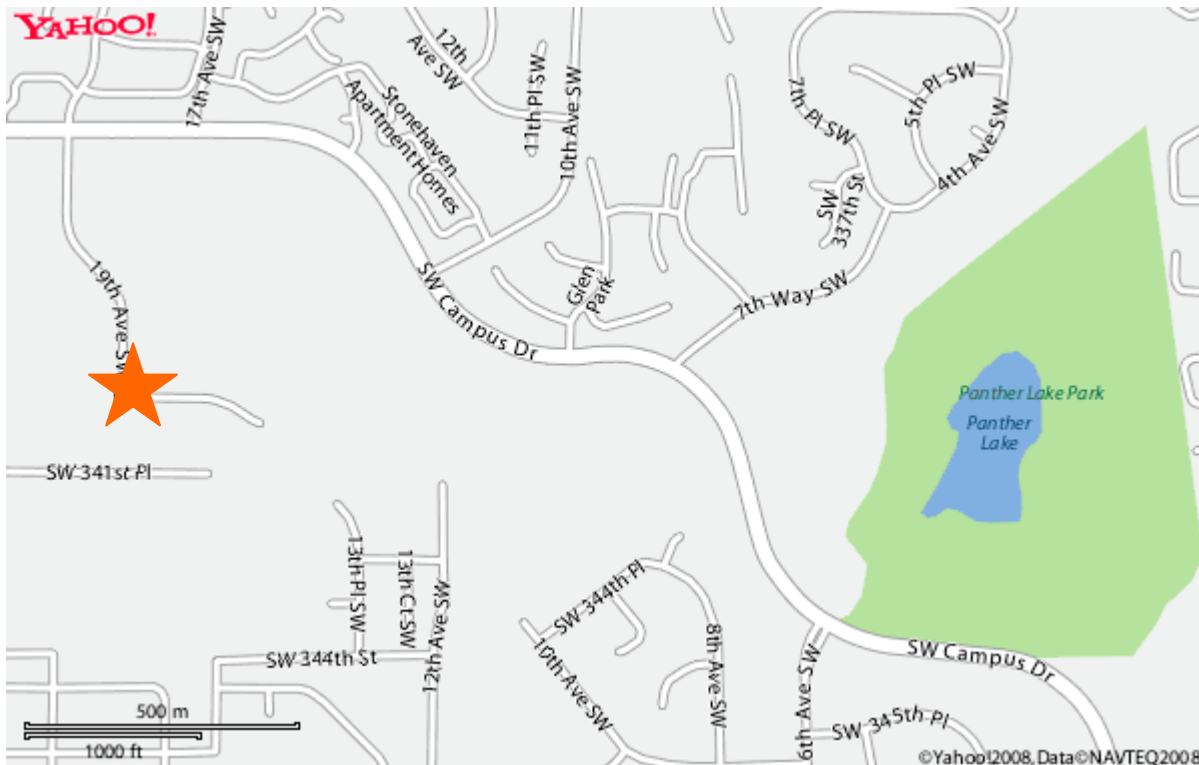

**\*\*\*PLEASE NOTE DIRECTIONS TO ALTERNATIVE PARKING AREA\*\*\***

## **Steel Lake Park Annex (Games) (SL 1, SL 2)**

2620 S 312<sup>th</sup> St  
Federal Way, WA 98003

## **Please park at Harry S. Truman High School (adjacent to fields)**

31455 28<sup>th</sup> Ave S  
Federal Way, WA 98003



### ***Directions from I-5:***

- Head North or South I-5 toward Federal Way.
- Take Exit 143 (S. 320<sup>th</sup> St.)
- Go west on 320<sup>th</sup> St. and turn right onto 23<sup>rd</sup> Ave. S.
- Turn right onto S 317th St.
- Continue around the traffic circle/roundabout. Exit the roundabout onto 28<sup>th</sup>. Ave S
- Turn left **into Harry S. Truman High School parking lot.** Follow signs to fields

### ***Directions from the Complex:***

- Turn left out of Complex onto SW Campus Drive (becomes SW 348<sup>th</sup> St.)
- Turn left at Pacific Hwy S.
- Follow Pacific Hwy S. to 312<sup>th</sup> St.
- Turn right at 312<sup>th</sup> St. and continue east to the end of the road (you will pass the park).
- Take a right onto 28<sup>th</sup> Ave S.
- Take a right into **Harry S. Truman High School parking lot.** Follow signs to fields

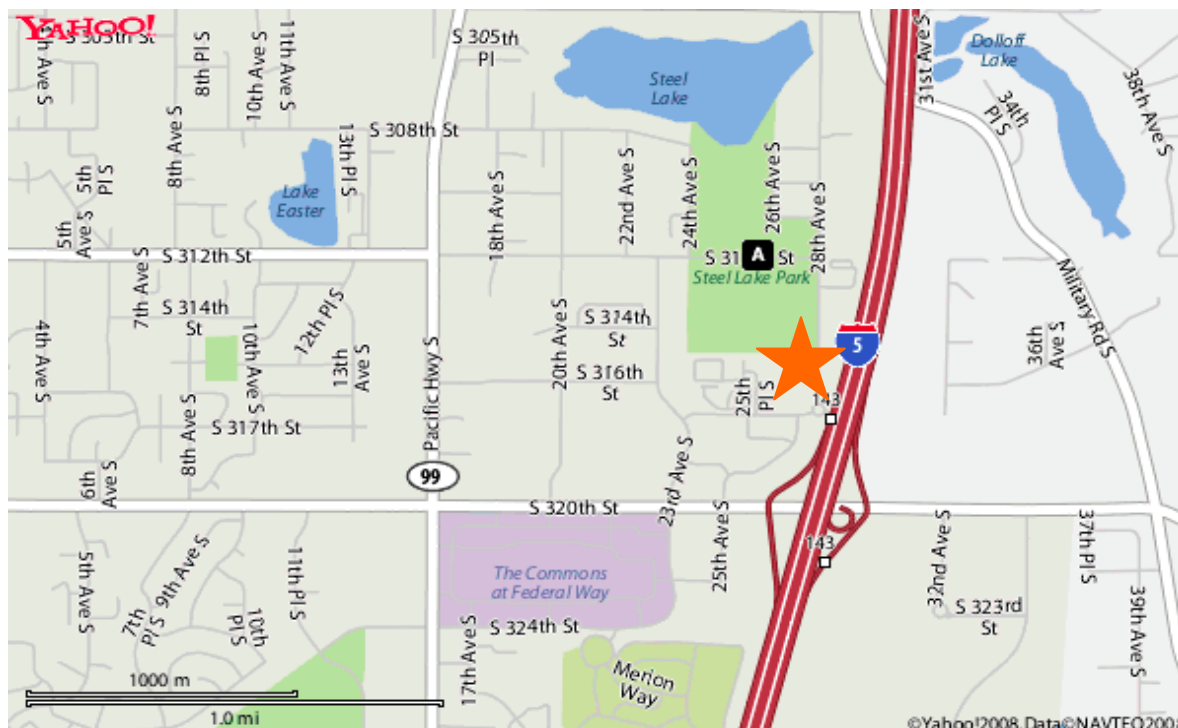

# Todd Beamer High School (TBHS)

35999 16th Ave S  
Federal Way, WA 98003



## ***Directions from I-5:***

- Head North or South I-5 toward Federal Way.
- Take Exit 142B (348<sup>th</sup> St.)
- Go West on S. 348<sup>th</sup>(becomes SW Campus Drive).
- Turn left onto Enchanted Parkway.
- Turn right at S. 356<sup>th</sup> St.
- Turn left at 16<sup>th</sup> Ave. S. continue straight through the traffic circle/roundabout
- Todd Beamer will be on the right.

## ***Directions from the Complex:***

- Turn left out of Complex onto SW Campus Drive (becomes S. 348<sup>th</sup> St.)
- Turn right at 1<sup>st</sup> Avenue.
- Turn left at S. 356<sup>th</sup> St.
- Go thru intersection at Pacific Hwy and continue east.
- Turn right at 16<sup>th</sup> Ave. S. continue straight through the traffic circle/roundabout
- Todd Beamer will be on the right.

